



A high impact lightbox display solution, just add your own graphics. Ideal for promotional displays

features & benefits

- 'D' shaped profile lightbox
- Available in A1, A2 and A3 sizes
- Snap frame sides enable easy change of graphics
- Complete with TFL cool fluorescent tube, mains lead and plug
- Quality aluminium frame construction
- Wall fixing, portrait or landscape
- UPVC protective graphics covers
- CE approved

technical information

- Suitable for indoor use only
- Fluorescent tube specification:
A1 size 20 watt; A2 size 16 watt; A3 size 8 watt
- Fluorescent tube life: 5000hrs approx
- Supplied complete with 1500mm approx
power lead and UK or Euro style plug



'D' shaped profile



Screw ports
for wall mounting

hardware specifications	graphic specifications	additional info
<p>ML901 (A1)</p> <p>Assembled Dimensions: 847mm (h) x 580mm (w) x 130mm (d) approx</p> <p>Weight: 5.3kgs approx</p>	<p>ML901 (A1)</p> <p>Recommended Graphic Dimensions: 841mm (h) x 594mm (w) approx</p> <p>Visible Graphic Dimensions: 841mm (h) x 571mm (w) approx</p>	<p>Availability:</p> <p>Moulded black end caps with anodised silver snap frame sides</p> <p>Recommended Graphic Substrate: 200 micron thick Duratrans or equivalent</p> <p>Maximum Graphic Thickness: 1mm</p>
<p>ML902 (A2)</p> <p>Assembled Dimensions: 600mm (h) x 410mm (w) x 110mm (d) approx</p> <p>Weight: 3kgs approx</p>	<p>ML902 (A2)</p> <p>Recommended Graphic Dimensions: 594mm (h) x 420mm (w) approx</p> <p>Visible Graphic Dimensions: 594mm (h) x 397mm (w) approx</p>	
<p>ML903 (A3)</p> <p>Assembled Dimensions: 420mm (h) x 290mm (w) x 95mm (d) approx</p> <p>Weight: 1.7kgs approx</p>	<p>ML903 (A3)</p> <p>Recommended Graphic Dimensions: 420mm (h) x 297mm (w) approx</p> <p>Visible Graphic Dimensions: 420mm (h) x 274mm (w) approx</p>	

Before assembling or changing graphics ensure the unit is disconnected from the power supply.



Open out both snap frame sides.

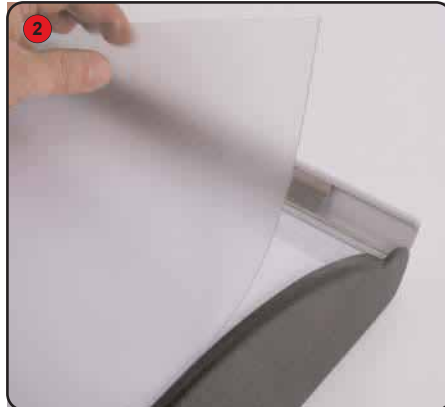

Remove the clear protective sheet.



Fit the graphic into the lightbox.



Re-fit the protective sheet over the graphic.



Close the snap frame sides to secure the graphic into place.

