

*Crescent is a stylish workstation or greeting counter constructed from MDF with high quality finish thermoformed laminated tops.*



**features & benefits**

- Constructed from composite materials and flexible MDF tambour
- Flat packed, easy to transport and quick to assemble
- No tools required
- Load bearing up to 75kgs approx  
Tops are available in Birch, Black or Silver thermoformed finishes
- Choice of Luxury Foam Backed Loop Nylon, Front Runner or Prelude fabric wrap colours
- Beech and Aluminium tambour wraps also available
- Optional internal shelf (extra cost option)
- Unit can be open or closed at the back



Crescent can be open or closed at the back

hardware specifications	wrap specifications	additional info
<b>Overall size (h) x (w) x (d):</b> 1000mm x 950mm x 565mm approx  <b>Weight:</b> 14.25kg approx  <b>Optional internal shelf size (w) x (d):</b> 490mm x 325 approx  <b>Useable internal shelf height:</b> 200mm approx	<b>Tambour Wrap dimensions (h) x (w):</b> 970mm x 2425mm approx  If applying a graphic to the wrap, an allowance should be made to its size to accommodate material type, thickness etc.  <b>Recommended visible size (h) x (w):</b> (for front of unit) 970mm x 1430mm approx	<b>Recommended carry bag/case:</b> AB176 Carry bag/ AC347A Carry case  <b>Optional extra cost accessories:</b> Cable management port Internal shelf

# Assembly Instructions

## Crescent assembly



Kit includes: Top, base and MDF tambour wrap (Optional internal shelf and poles shown)

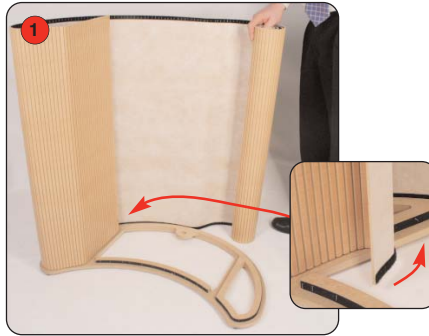

Lay the base on the floor, hook fastener side uppermost. Attach the tambour wrap to the base.



Continue to attach the wrap. At this stage you may decide to have the unit open or closed at the back.



Place the top onto the wrap and secure using the hook fastener.



Completed Crescent workstation.

## Optional Internal shelf assembly



Locate the twist and lock poles into the internal shelf. Ensure the arrows on the poles are all facing the same direction.

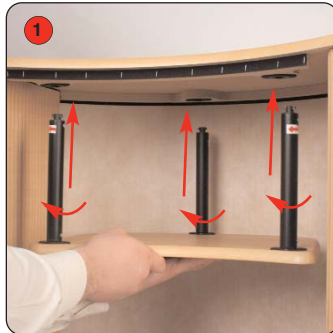

Locate the poles/shelf into fittings underneath the Crescent top. Rotate each pole in the arrow direction to lock the shelf in place.



Completed Internal shelf.

