

Forecourt Pole General Specifications

Overall Height	5.0 Metre
Length Of Top Section	2.5 Metre
Length Of Bottom Section	2.5 Metre
Inside Diameter [of both sections]	40.39 mm
Outside Diameter [of both sections]	44.45 mm
Packed Size	2.65 x 0.10 x 0.10 Metre
Packed Weight	5.5 Kg
Maximum Flag Size**	2.5 square metres

**(Maximum flag size - These are intended as a guide for normal weather conditions. During strong winds and highly inclement weather Storm-Flags should be flown)

Forecourt Pole Wall Bracket Specifications

Part	Description	Bracket A	Bracket B
A	Distance between grub screws	85mm	N/A
B	Height of bracket	120mm	47mm
C	Internal Diameter of bracket	50mm	50mm
D	External Diameter of bracket	60mm	60mm
E	Distance between Holes	90mm	83mm
F	Height of baseplate	125mm	55mm
G	Width of baseplate	60mm	110mm

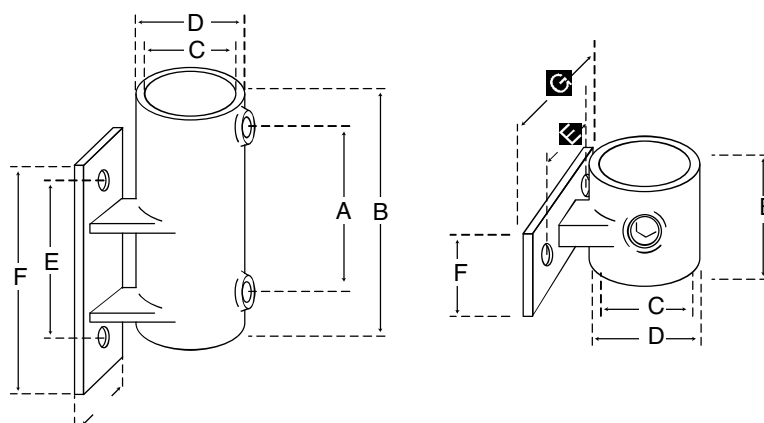

Forecourt Pole With The Wedge & Optional Claw Kit

FM030800

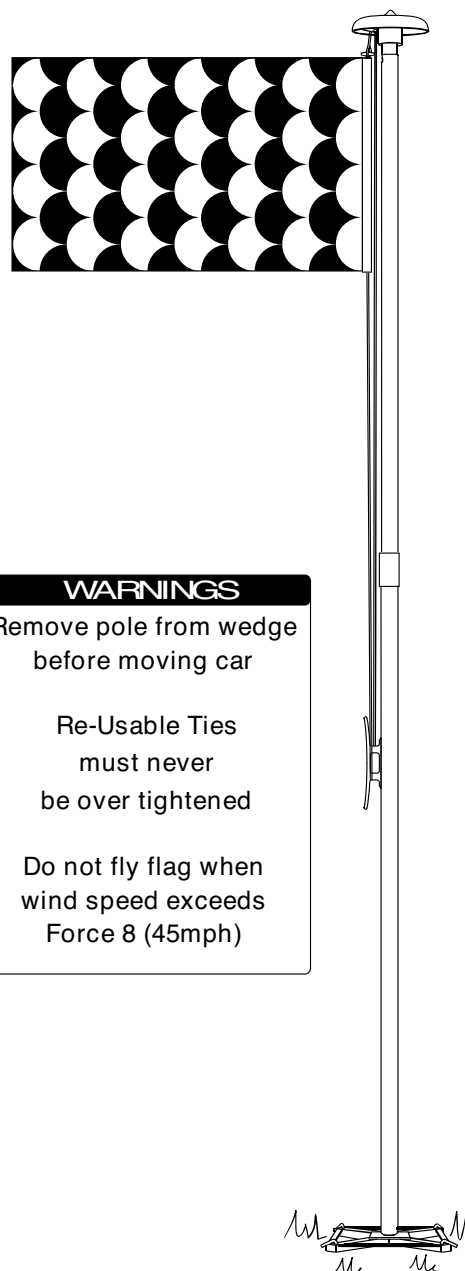
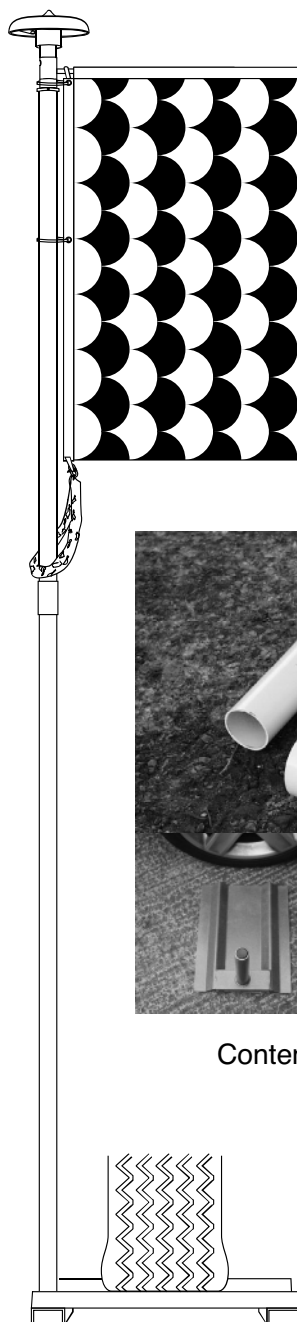

Contents of Forecourt Pole Kit

WARNINGS

Remove pole from wedge
before moving car

Re-Usable Ties
must never
be over tightened

Do not fly flag when
wind speed exceeds
Force 8 (45mph)

Optional Claw Kit

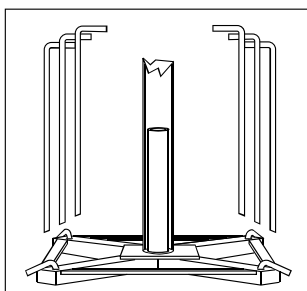

- 1 Claw to be used on grass only.
- 2 Make sure ground is level and firm.
- 3 Secure the Claw to the ground with the six pegs provided and erect the pole onto it.

Forecourt Pole Assembly Instructions For Pole With Halyard & Cleat

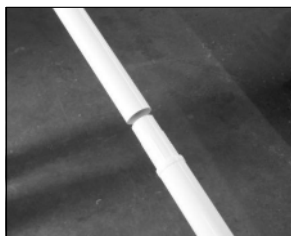

STEP 1

First unpack the kit and check contents illustrated on page one with the 'wedge' inset.

Assemble the two sections of the flagpole by inserting the plain section into the plastic joint, ensuring that it is inserted all the way home [the travel will be approx. 60mm].



STEP 2

Remove the aluminium flag arm from the rotating portion of the truckhead adaptor mount the entire unit onto top of the plain aluminium section.

Mount the finial onto the truckhead unit, making sure you push it firmly home.



STEP 3

Pass the two ends of the halyard through the finial from the top direction and pull the whole length of the halyard through so that both parts are equal.



STEP 4

Place the 'Wedge' in front of the vehicle so that it can be mounted.

Drive the vehicle onto the 'Wedge' so that it is securely anchored but ensuring adequate clearance for the pole to prevent any possibility of damage to the vehicle.



STEP 5

Mount the pole onto the 'Wedge' ensuring that the spigot is fully inserted into the pole.



STEP 6

Position the cleat at the desired height first having ensured that the halyard will reach it. Drill the two holes and secure with the self tapping screws as supplied.



STEP 7

Attach the halyard to the flag by tying the each end of the halyard to the 'D' rings on the flag .



STEP 8

Hoist the flag up the pole ensuring it is the correct way up. Secure the halyard to the cleat.

[NEVER remove the vehicle from the 'Wedge' without first removing the pole]

Forecourt Pole Assembly Instructions For Pole With Arm

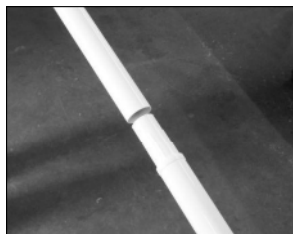

STEP1
First unpack the kit and check contents illustrated on page one with the 'wedge' inset..

Assemble the two sections of the flagpole by inserting the plain section into the plastic joint, ensuring that it is inserted all the way home [the travel will be approx. 60mm].



STEP 2

Place the chain over the pole.

Mount the rotating arm unit onto the top of the plain aluminium section.



STEP 3

Mount the finial onto the truckhead unit, making sure you push it firmly home.



STEP 4

Place the 'Wedge' in front of the vehicle so that it can be mounted.

Drive the vehicle onto the 'Wedge' so that it is securely anchored but ensuring adequate clearance for the pole to prevent any possibility of damage to the vehicle.



STEP 5

Slide the arm through the sleeve at the top of the flag.



STEP 6

Secure the plastic tie through the eyelet at the top of the flag and around the rotating arm unit. Ensure that the rotating arm unit moves freely.

[Re-Usable Ties must never be over tightened.]



STEP 7

Secure the remaining plastic tie through the eyelet and around the pole.

[Re-Usable Ties must never be over tightened.]

Attach the chain to the 'D' ring at the bottom of the flag.



STEP 8

Mount the pole onto the 'Wedge' ensuring that the spigot is fully inserted into the pole.

Make sure that the arm unit can rotate freely and clears all potential obstacles.

[NEVER remove the vehicle from the 'Wedge' without first removing the pole]