

Modulate Sloped Frames

Modulate 824 (Slope 2)

Aug 2018

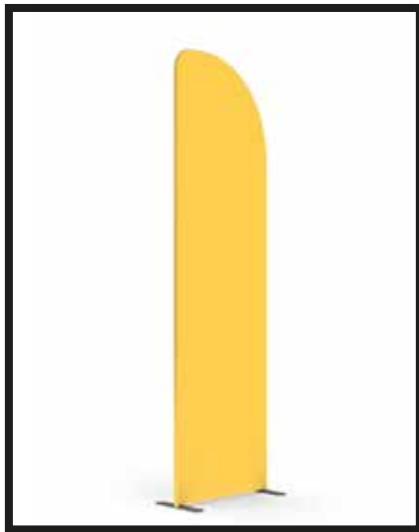

PARTS (NOT TO SCALE)

Top Pole Section



Top Corner Radius Section



Vertical Pole Sections

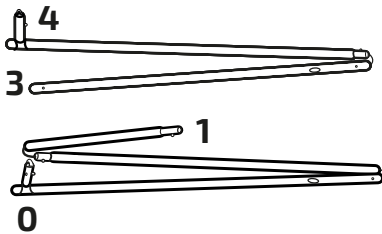

Support Pole



Bottom Pole



Feet

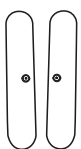

Gloves



Optional Half Feet

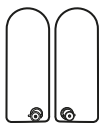

NOT SUPPLIED WITH KIT AND THEY ARE SOLD SEPARATELY

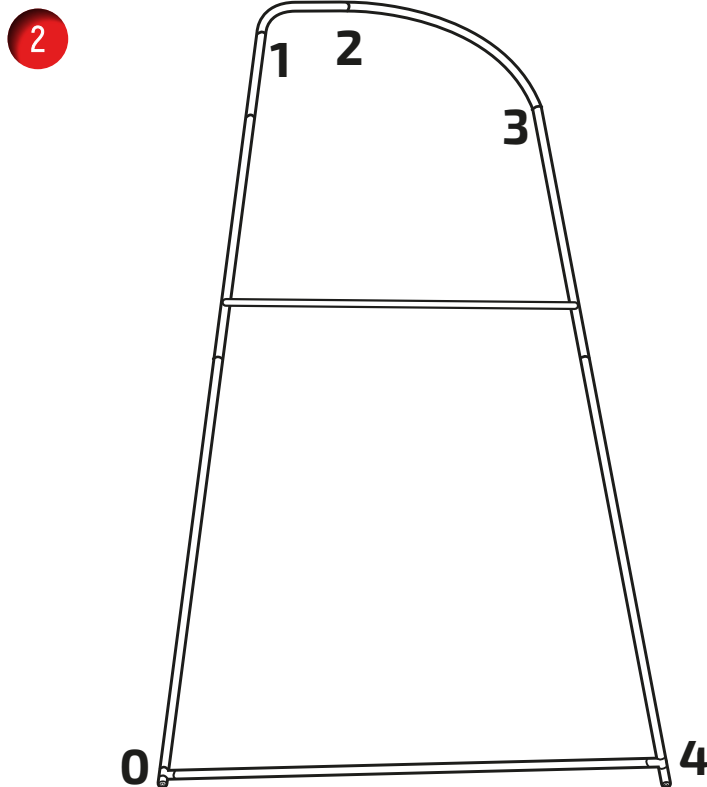
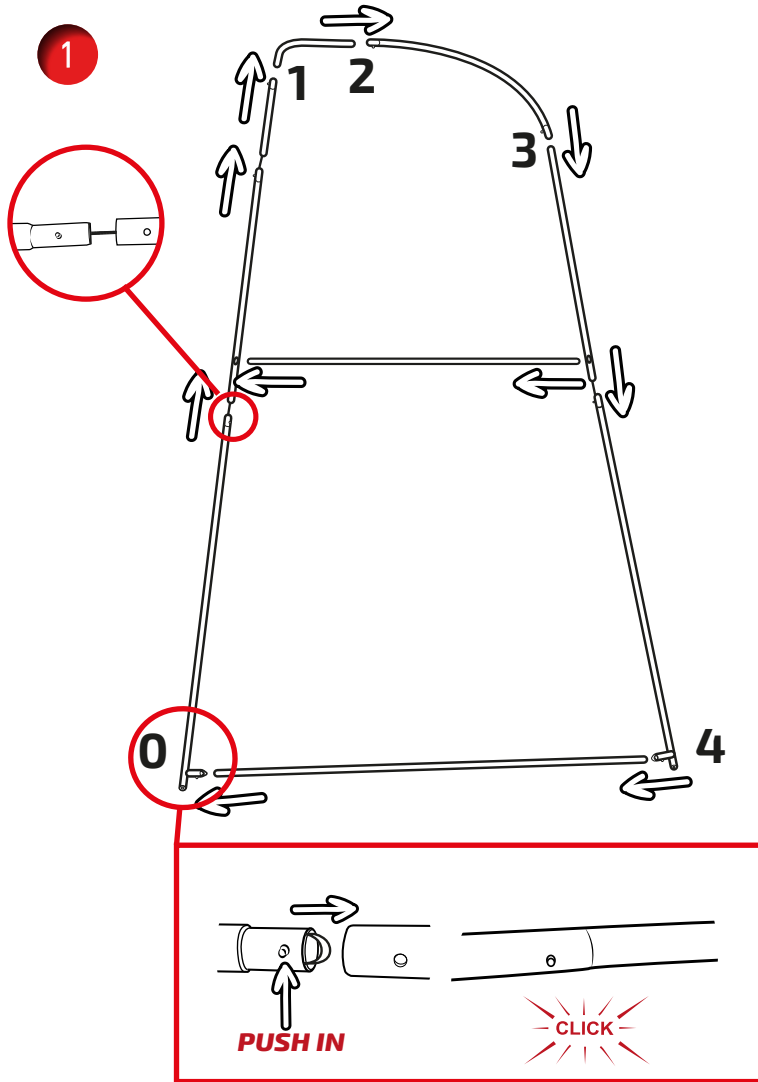

Modulate Sloped Frames Modulate 824 (Slope 2)

Aug 2018

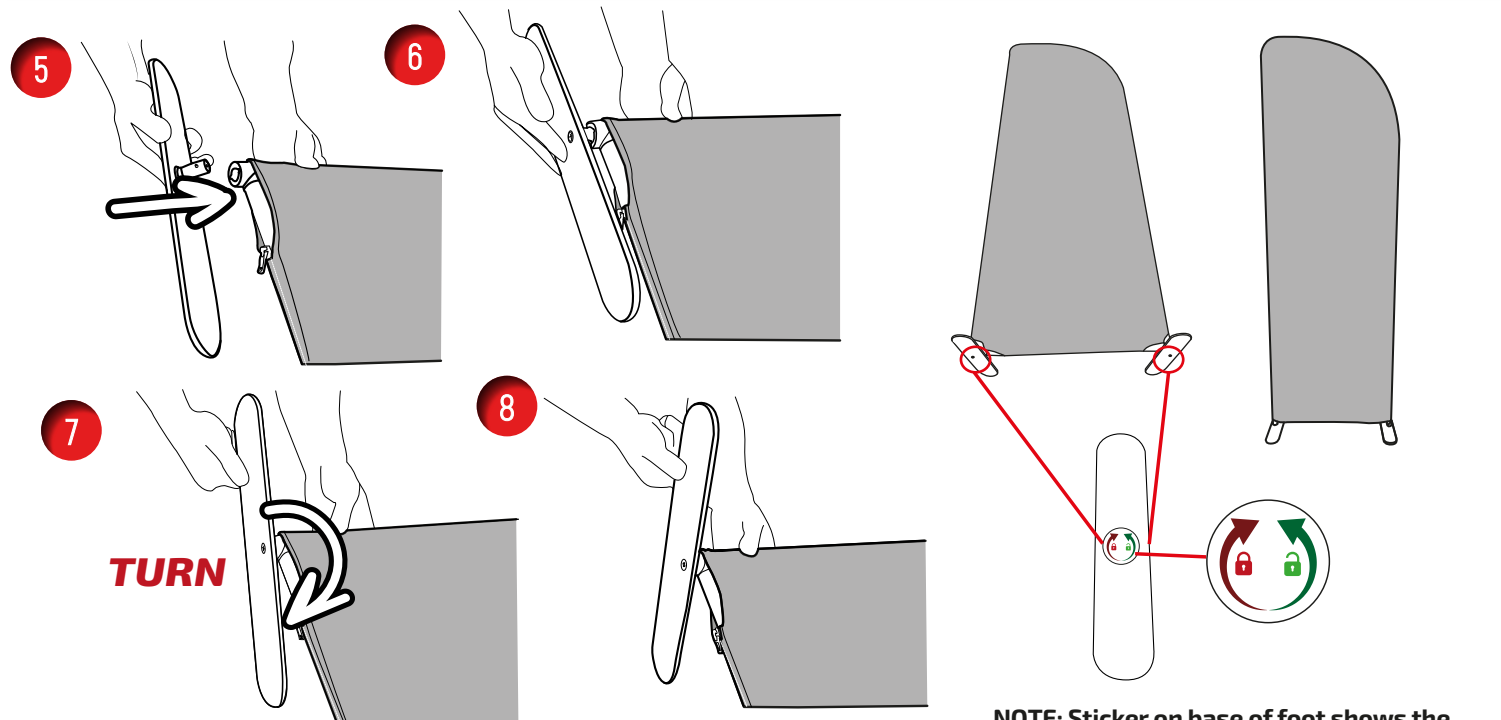
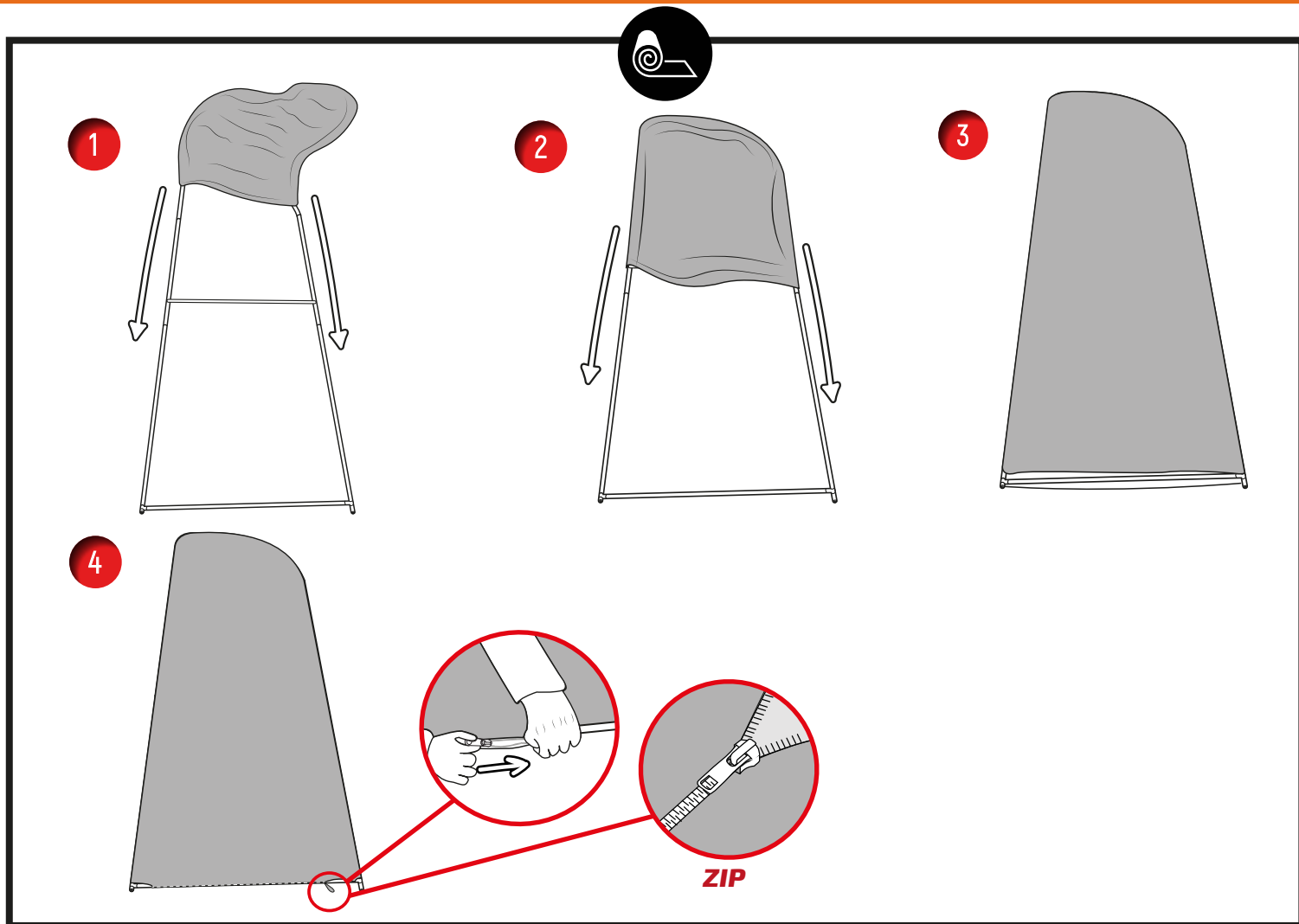

Turn clockwise to lock foot in position
Turn anti-clockwise to unlock foot

NOTE: Sticker on base of foot shows the directions for locking/unlocking foot

NOTE: TWO POSITIONS FOR THE FEET (SEE OPTION 1 FOR SECOND POSITION)



OPTIONAL (HALF FEET)

OPTION 1 NOTE: HALF FEET CAN BE POSITIONED ONTO THE FRAME TWO DIFFERENT WAYS

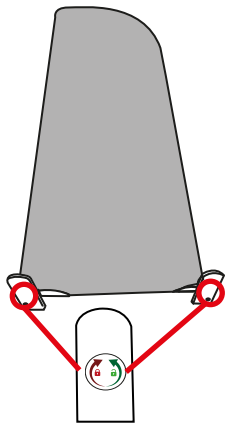
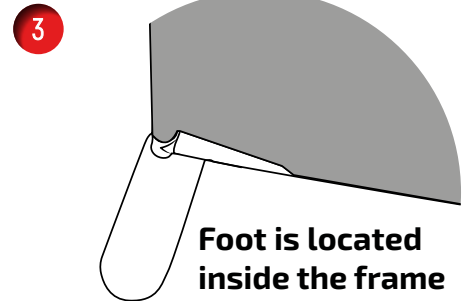
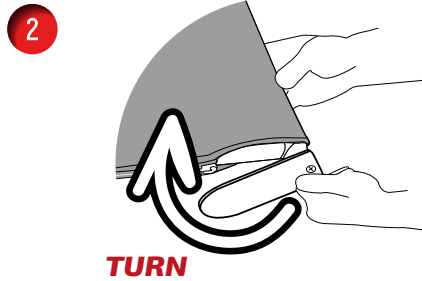
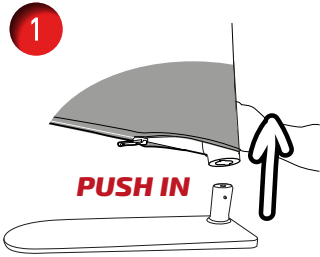

Turn clockwise to lock foot in position
Turn anti-clockwise to unlock foot

OPTION 2

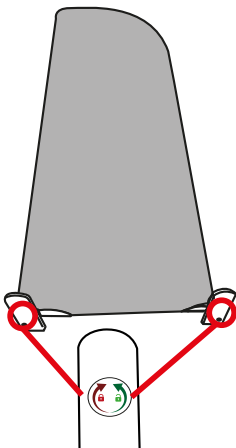
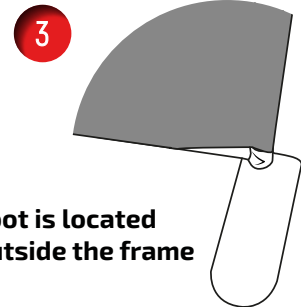
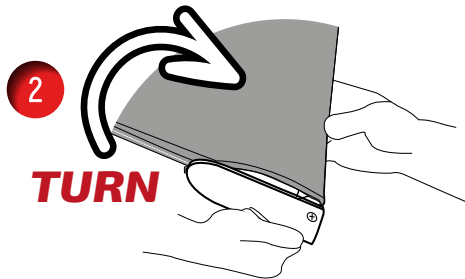
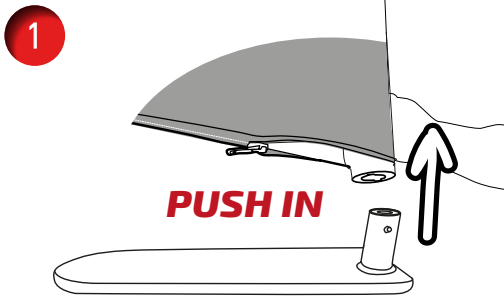

Turn clockwise to lock foot in position
Turn anti-clockwise to unlock foot

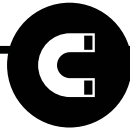

CONNECTING MULTIPLE FRAMES

NOTE: SECOND FRAME (820 CURVED NOT INCLUDED)

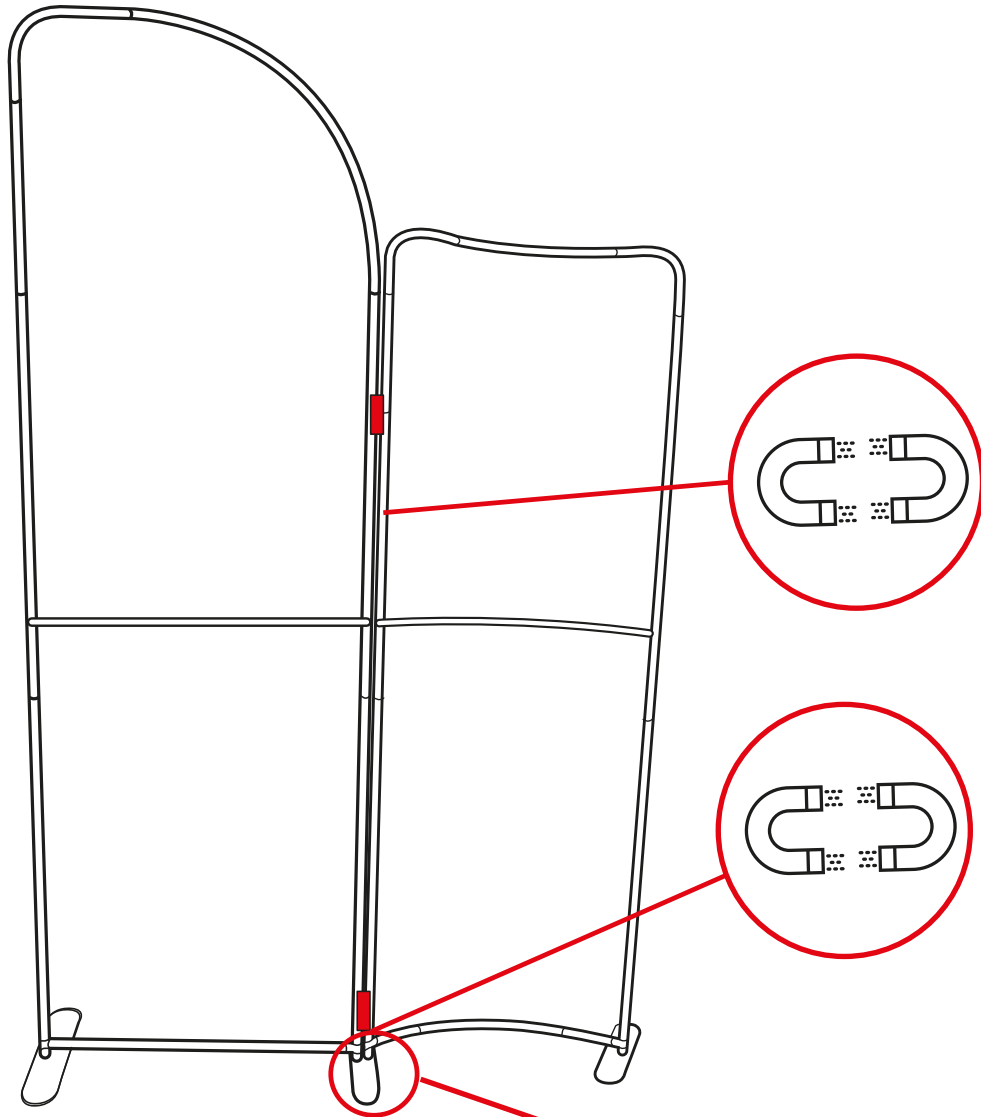

824 Slope 2 Frame and 820 Curved Frame

Remove one foot from second frame and align both frames on one foot

NOTE: FOLLOW OPTION 2 FOR HALF FEET TO CONNECT TWO FRAMES ON ONE FOOT

