

Retail Column

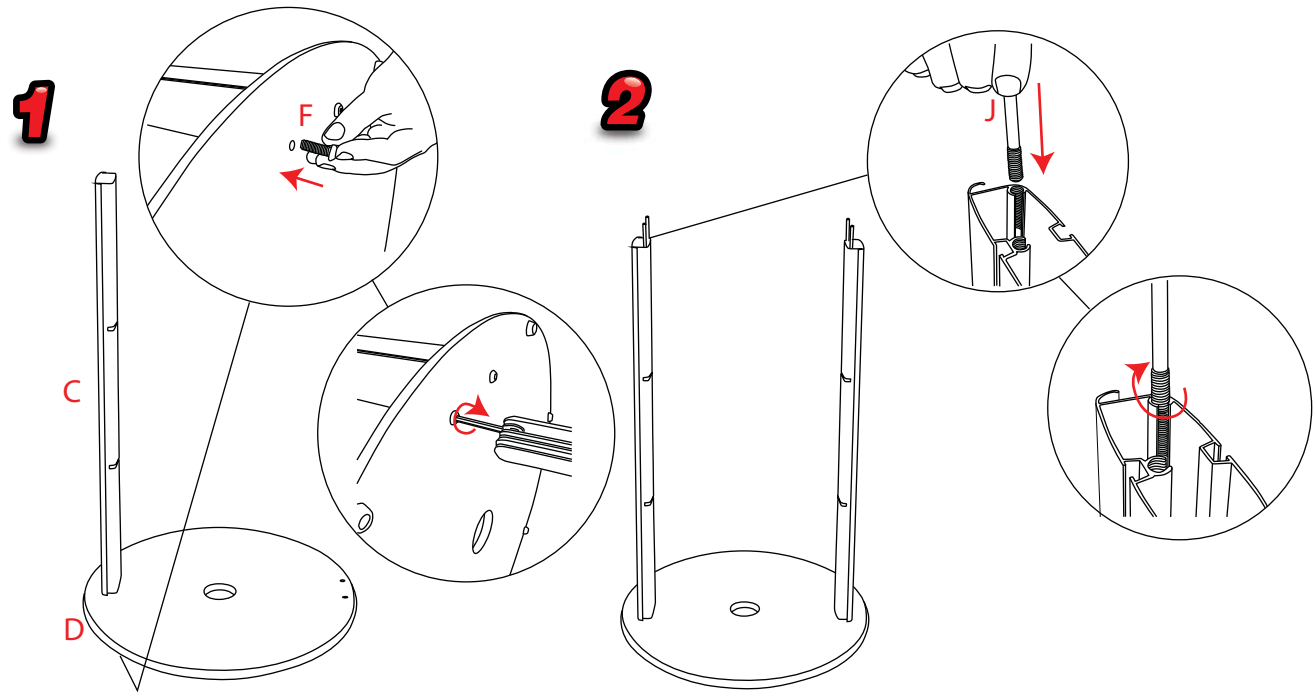

Half Graphic Visible Area(mm):
895(h) x 497(w)
Full Graphic Visible Area(mm):
1800(h) x 497(w)
Maximum Graphic Thickness
3mm
Hardware Dimensions(mm):
1840(h) x 500(w) x 650mm(d)
Weight: 10kg
Slatwall Weight: 4kg
Acrylic Shelf Weight: 700g

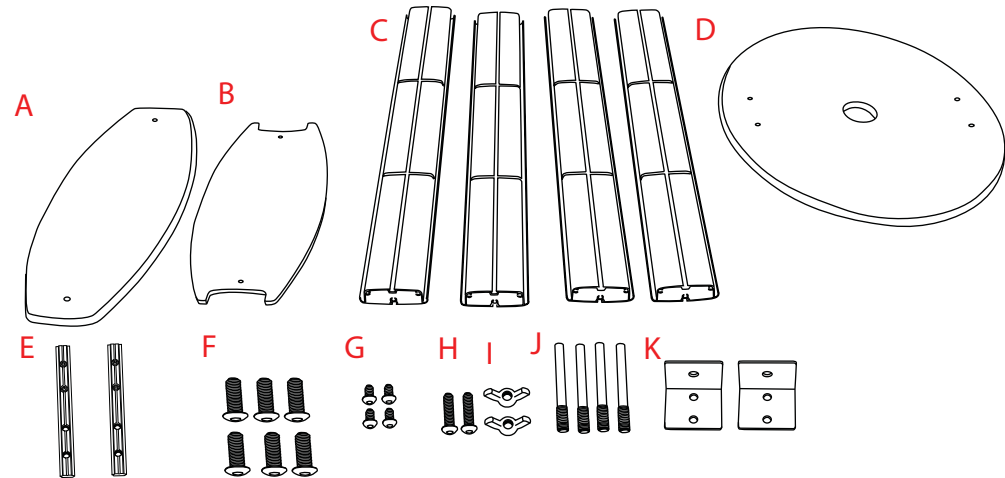

Retail Column

Installation

Retail Column

3

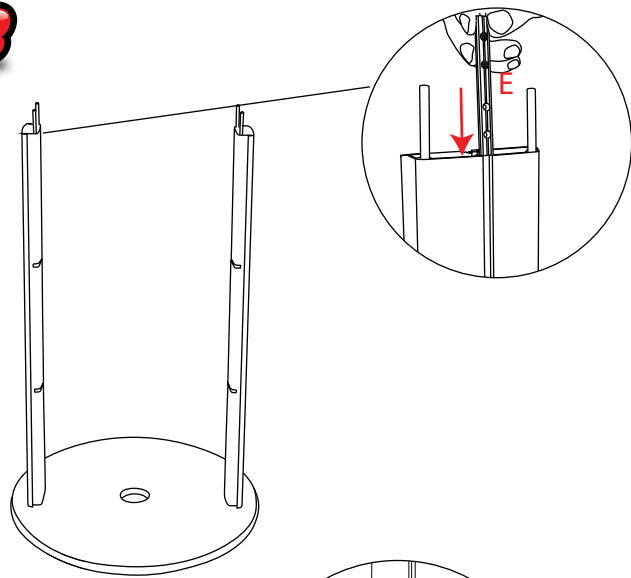

4

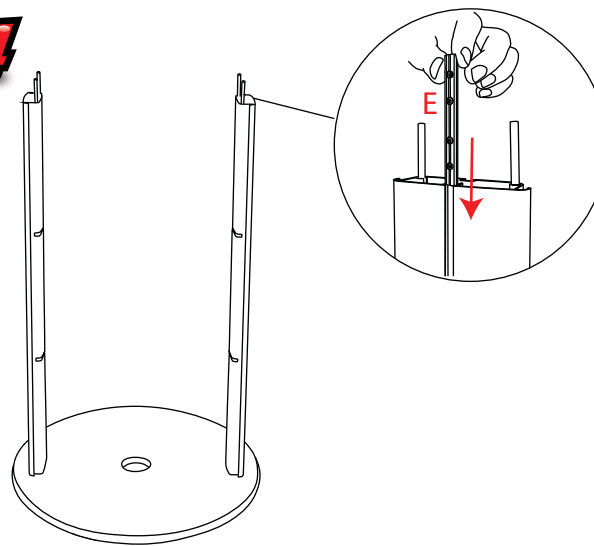

5

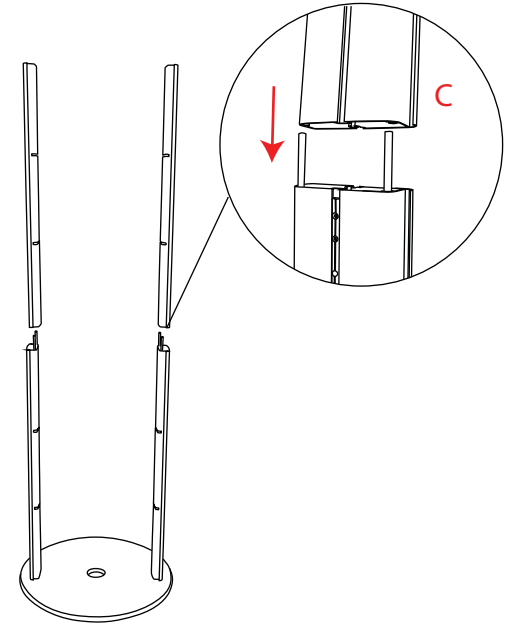

6

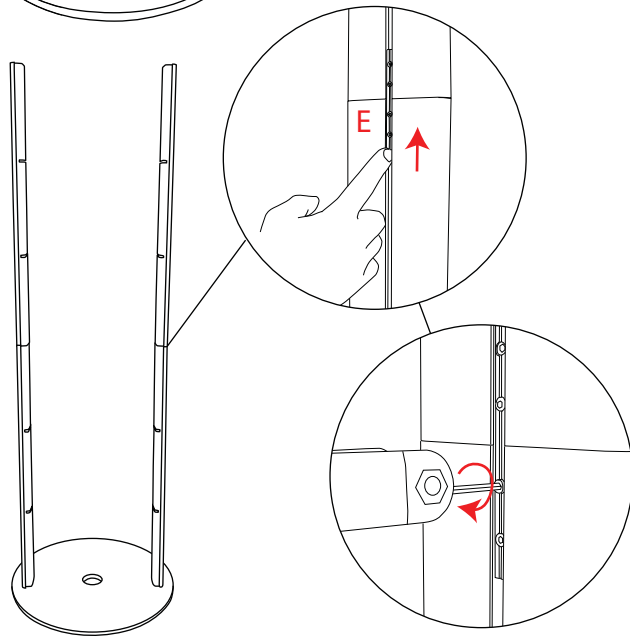

7

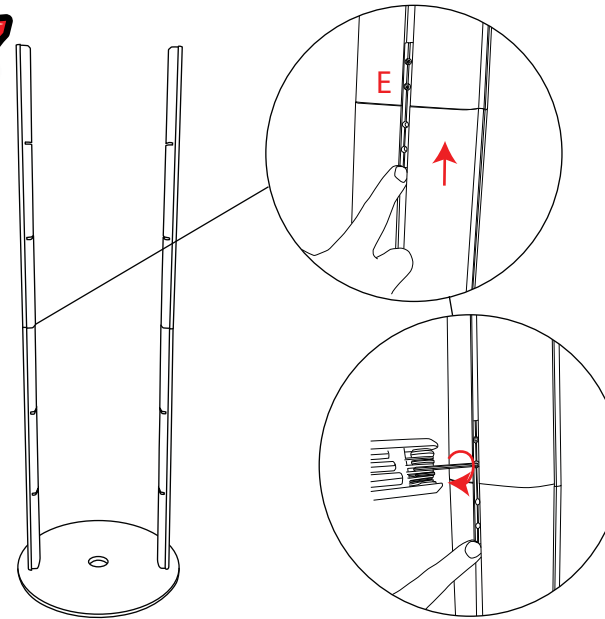

Retail Column

Installation

Retail Column

8

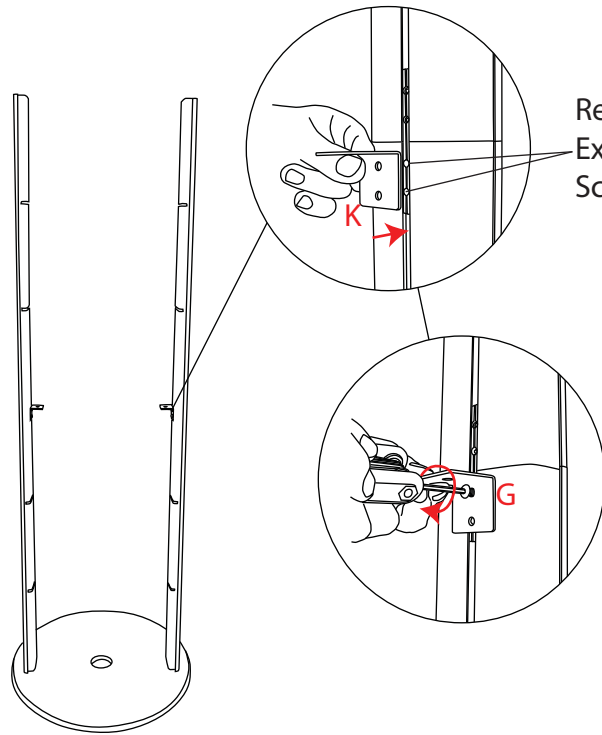

Remove
Existing Grub
Screws

9

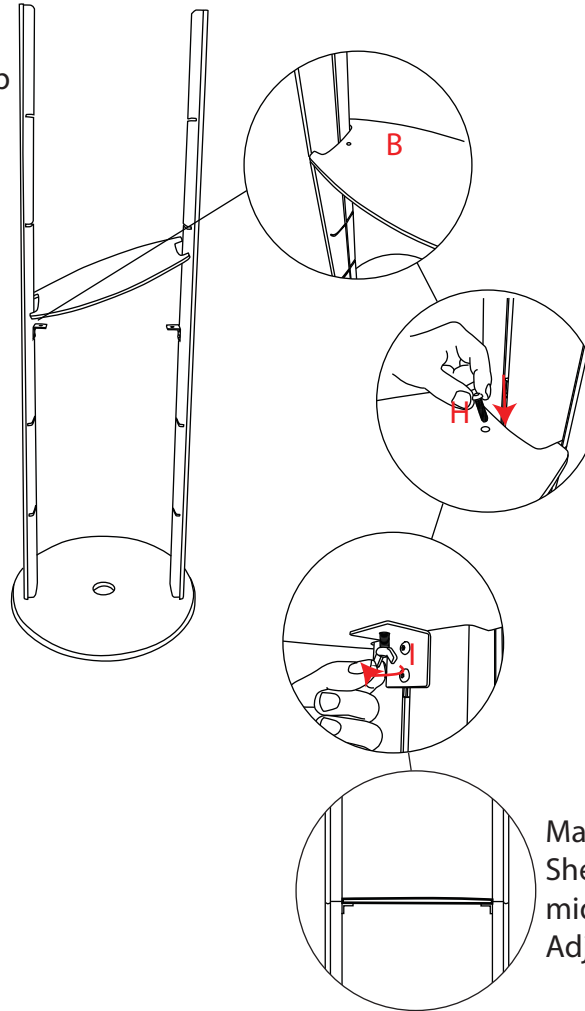

10

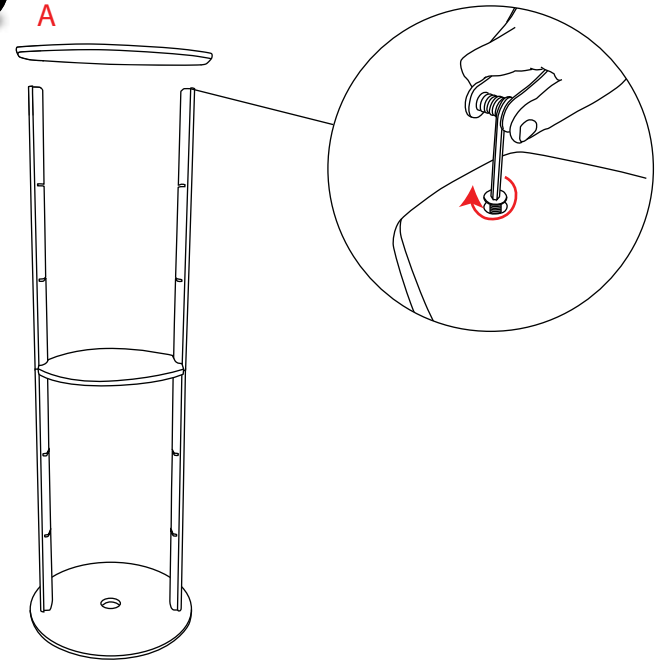

Make sure the
Shelf is located in the
middle of the joint on the upright.
Adjust if necessary.

Retail Column

Optional Slatwall

1

Complete Step 1 on Retail Column frame.

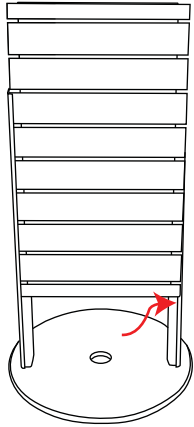

Slat Wall Orientation
This way up.

2

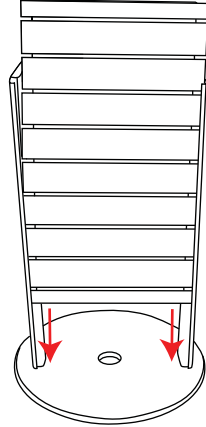

Once slat wall is inserted complete steps 2-10 on Retail Column frame.

1

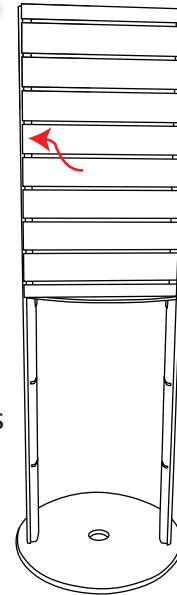

Complete steps 1-9 on Retail Column frame.

2

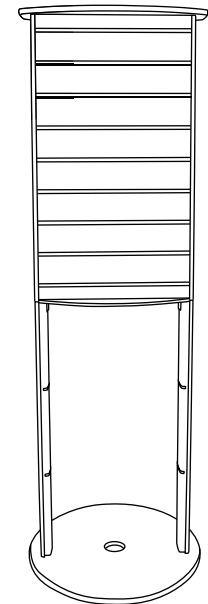

Complete steps 10 Retail Column Frame.

Optional Acrylic Shelves

1

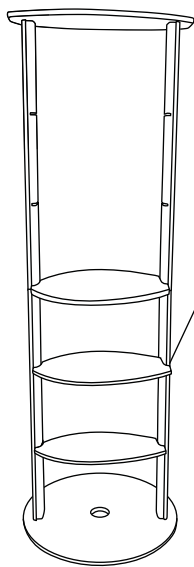

Linking Bars to be inserted at stage 3 or 6 depending on which half the shelves are fitted.

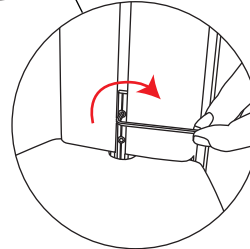
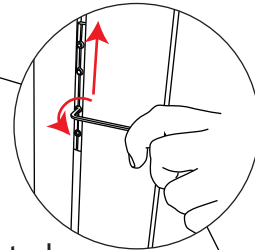
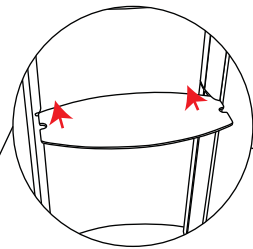

Retail Column

Lightbox

Instructions for
RGB LED lights
Note: White LED lights
do not have a
controller

1

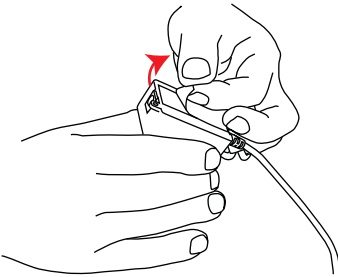

2

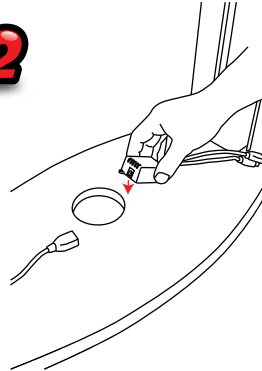

3

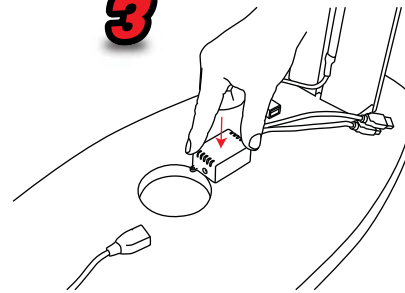

4

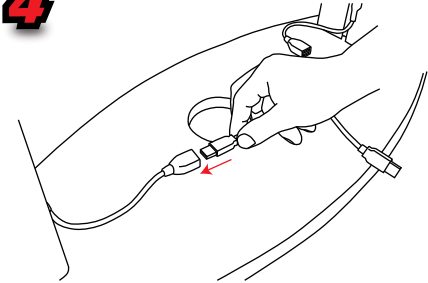

5

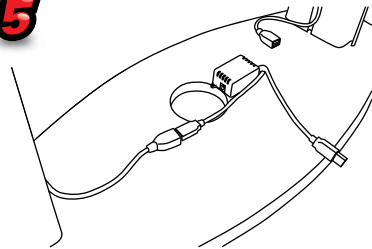

6

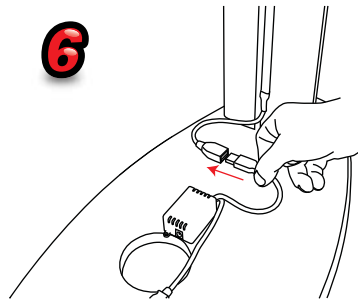

7

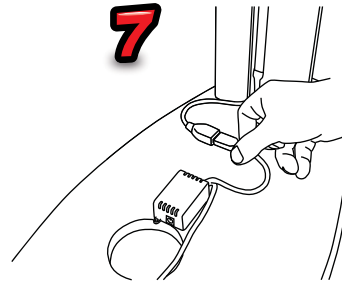

8

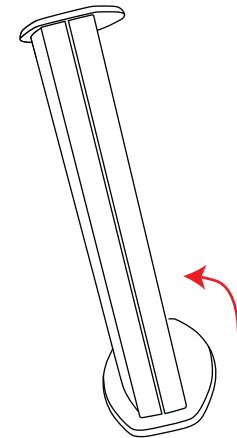

9

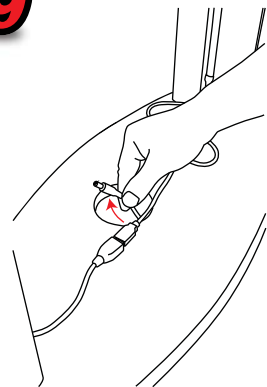

10

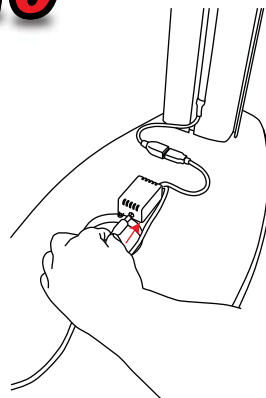

11

